

**DX170**  
(MTL5000 Series Enclosures)

**Dimensions (mm)**

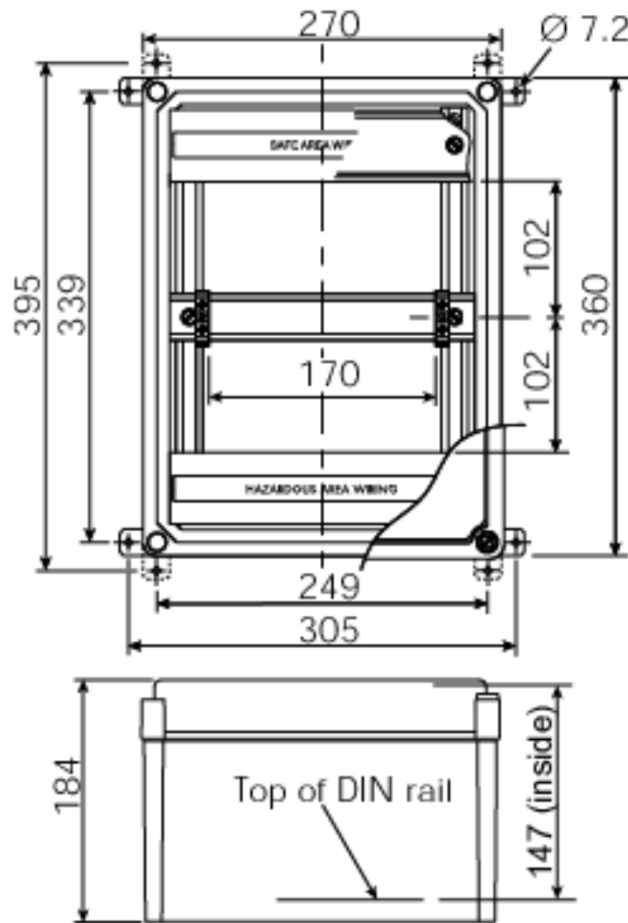

**Specification**

**Construction**

Glass reinforced polyester base  
Transparent polycarbonate lid

**Protection**

Dust-tight and water-jet proof to IEC529:IP65

**Lid fixing**

Captive fixing screws

**Weight (excluding barriers / isolators) kg**

2.6 kg

**Items provided**

DIN rail - fitted  
ETL7000 Earth terminals (2x) - fitted  
"Take care IS" front adhesive label  
Cable trunking

Note: Barriers or isolators are not included.

**Mounting**

Wall fixing lugs provided. For further details refer to INM5000

**Tagging and earth rail**

Accommodates MTL5000 series accessories.

**Permitted location**

Safe area  
FM and CSA Div.2, Class I (gases)  
Not Div. 2, Class II (dust ignition proof)

**Approximate capacities (on DIN rail between earth terminals)**

10 (8)\*  
\*use these figures when IMB57 mounting blocks for tagging/earth are included.

**Ambient temperature limits**

Dependent on units fitted.  
See instruction manual INM5000.

REV.						
PROJECT NAME:	Cooper Industries Japan K.K.			Title		
	Tokyo, Japan			DX170 Specification		
USER NAME :	TEL: +81-(0)3-6430-3128			SIZE	FSCM NO	Drawing No.
	FAX: +81-(0)3-6430-3129					rev
JOB NAME:	DATE:	2009/8/4		SS-DX170(E)		
Ref no.:	CHKD	K.T	DRAWN	I.S	SCALE	N/A
						SHEET 1 / 1